



Department of Health and Environmental Control

4130 Faber Place, Suite 300  
Charleston, SC 29405

Commissioner: Douglas E. Bryant

Board: John H. Burriss, Chairman  
Sandra J. Molander, Secretary

Promoting Health, Protecting the Environment

Richard E. Jabbour, DDS,  
William M. Hull, Jr., MD  
Roger Leaks, Jr.

**Office of Ocean and Coastal Resource Management**

H. Wayne Beam, Ph.D., Deputy Commissioner

Christopher L. Brooks, Assistant Deputy Commissioner

(803) 744-5838

(803) 744-5847 (fax)

January 18, 1996

Mr. Donald Jones  
Seamon, Whiteside, & Associates, Inc.  
753 Johnnie Dodds Boulevard  
Charleston, South Carolina 29464

Re: Gift Plantation, Phase II  
Dock Master Plan

Dear Mr. Jones:

Ocean and Coastal Resource Management planning and permitting staff have reviewed the dock master plan dated November 28, 1995 for Gift Plantation, Phase II development on the Stono River, near Charleston, in Charleston County, South Carolina. Your plan meets submittal requirements and is approved. This dock master plan will be used as an advisory opinion in permitting, but designation of any lot as a "dock lot" does not guarantee the issuance of any permits. The following comments will also be made part of the file and any subsequent permit review.

1. Lots 84 through 88 qualify for 50 square foot fixed pierheads only
2. Roofs will be evaluated at the time of permit application. Precedent in the vicinity for similar structures will be considered when evaluating applications for roofs.

This letter will be made part of the dock master plan file and will be considered as part of any future permit review. Additional concerns and further restrictions may occur as part of the permit public review. Reference must be given to this dock master plan in all contracts for sale of affected lots. This master plan shall be presumed to take precedence over applications inconsistent with this plan unless new information is revealed in an application to address and overcome the concerns identified in the dock master plan. If you have questions, please contact me.

Sincerely,

Richard Chinnis  
Permit Coordinator

cc: Dr. H. Wayne Beam  
Mr. Christopher L. Brooks  
Mr. Fritz Aichele  
Mr. Joe Fersner

SEAMON, WHITESIDE & ASSOCIATES, INC. 753 HIGHWAY 17 BY-PASS, MOUNT PLEASANT, S.C. 29504 PHONE (803) 304-1007

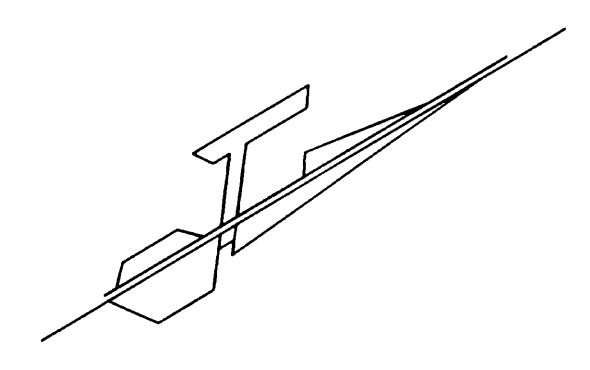
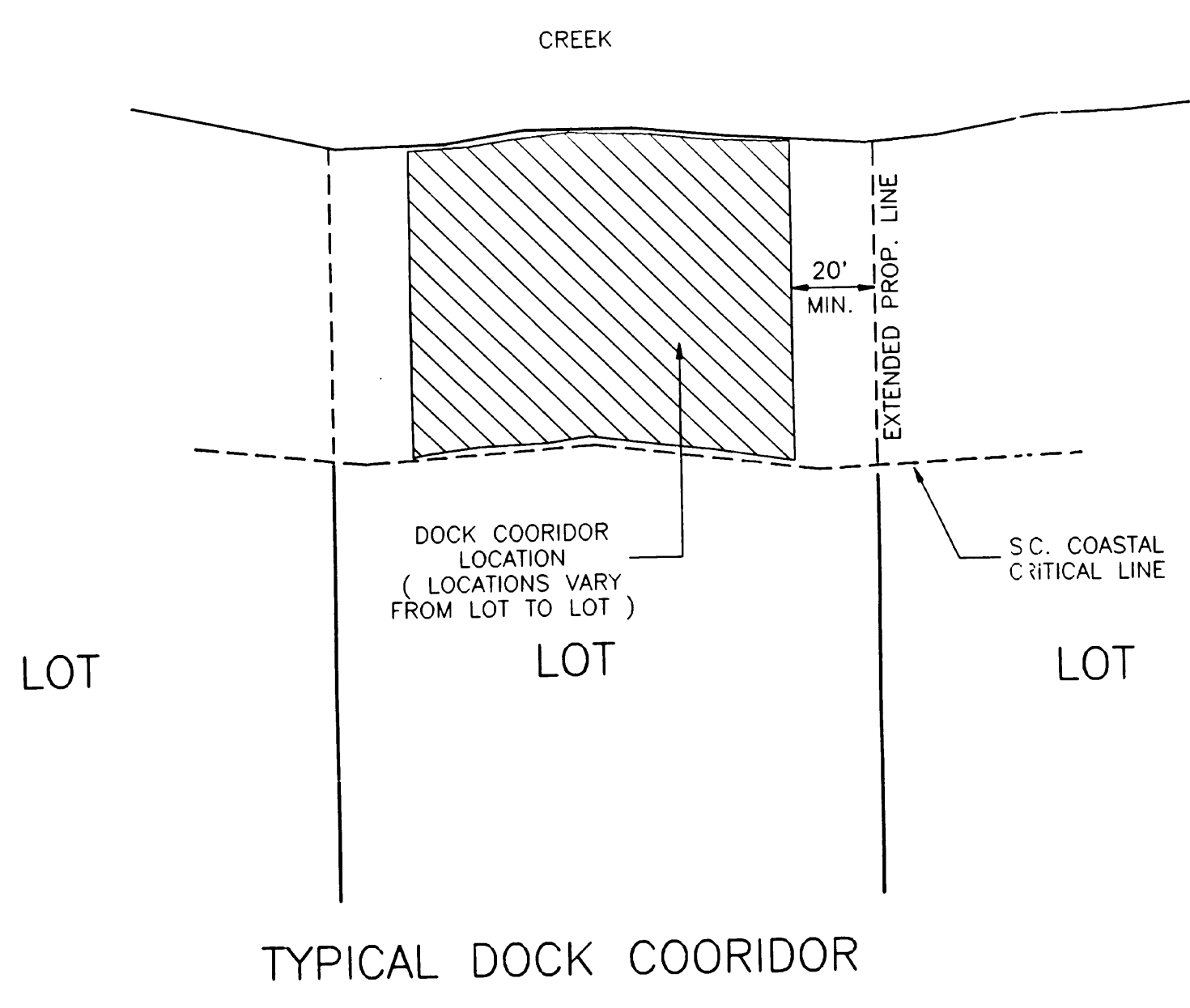

NO.	REVISION	DR.	DATE
12-14-95	WDR		
11-28-95	DCJ		
9-20-93	DCJ		
4-3-91	DCJ		
3-15-91	DCJ		
0	ISSUED		

DOCK  
CORRIDOR  
PLAN  
FILE: 1813 DATE: 3-15-91

PHASE I & II OF  
GIFT PLANTATION  
JOHNS ISLAND  
CHARLESTON COUNTY, SOUTH CAROLINA

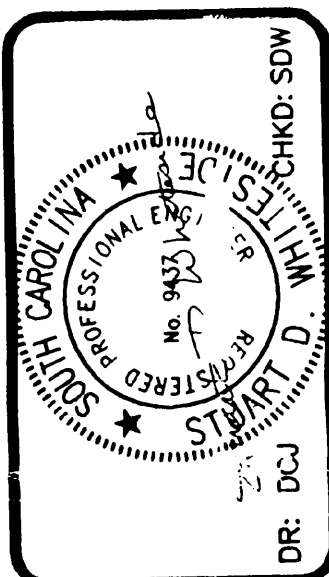

SEAMON, WHITESIDE & ASSOCIATES, INC.  
LANDSCAPE ARCHITECTURE/CIVIL ENGINEERING/PLANNING

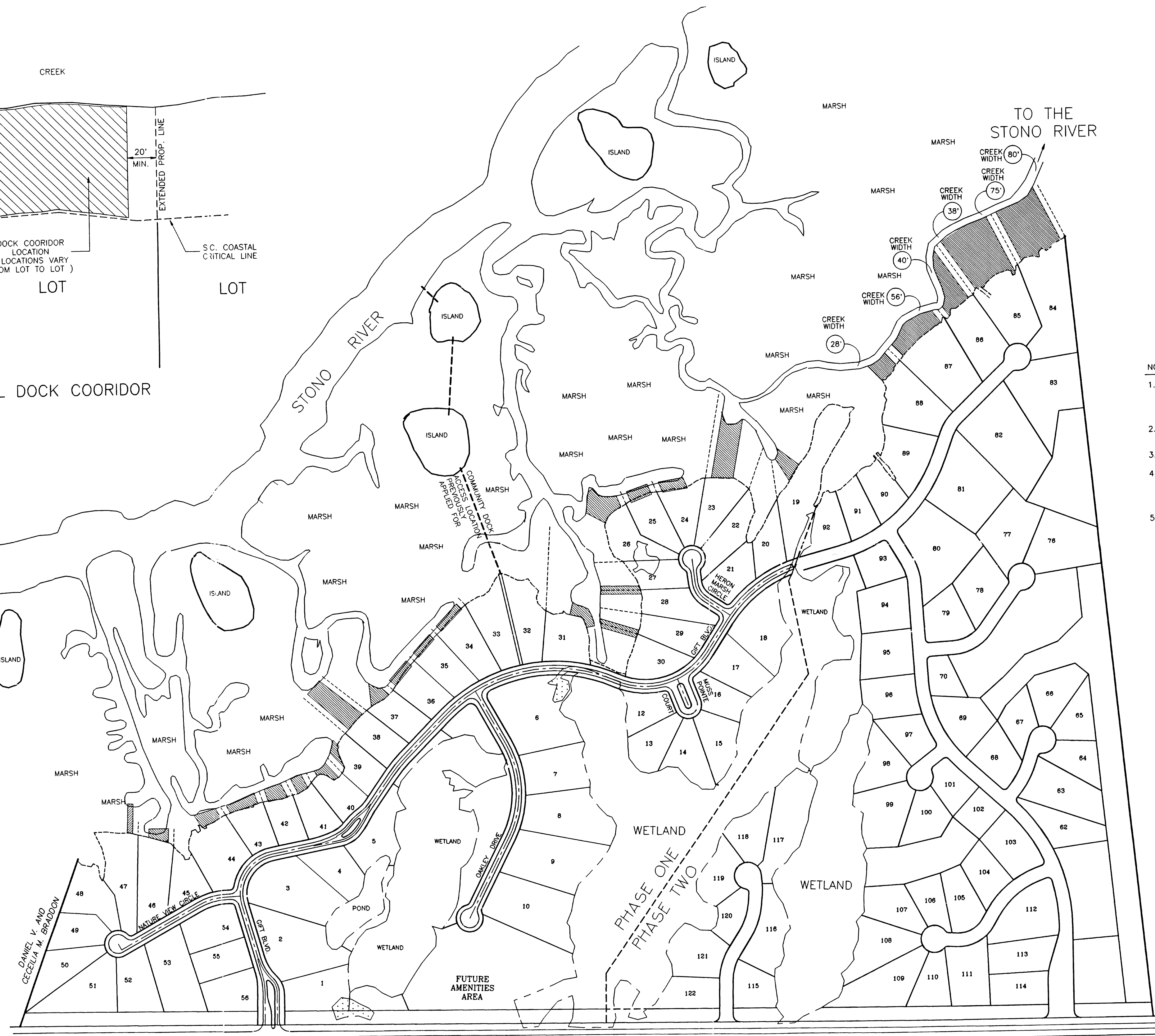

- NOTES:
- DOCK COORIDOR LOCATIONS SHOWN ARE FOR THE USE OF THE S.C. COASTAL COUNCIL AND DO NOT REPRESENT APPROVAL FOR A DOCK. INDIVIDUAL PROPERTY OWNERS MUST APPLY SEPARATELY FOR DOCK APPROVAL.
  - DOCK COORIDOR LOCATIONS SHOWN ARE NOT ABSOLUTE AND MAY VARY WITH THE APPLICATION TO THE S.C. COASTAL COUNCIL.
  - CREEK LOCATIONS AND SIZE SHOWN ARE APPROXIMATE.
  - THE LOTS DESIGNATED AS "FUTURE LOTS" MAY NOT QUALIFY FOR A DOC. SHOULD A FIELD INVESTIGATION BY THE S.C. COASTAL COUNCIL SHOW THAT THE CREEK IS LESS THAN 20 FEET WIDE. THIS MAY BE DETERMINED DURING A PERMIT APPLICATION.
  - ALL DOCK LOCATIONS SHOWN SHALL BE LIMITED TO A CRAB DOCK ONLY NOT TO EXCEED 50 SQUARE FEET. NO FLOATING DOCKS ARE PERMITTED IN THESE LOTS.

*lots 84-b 82*

S.C. HWY. #54 66' R/W

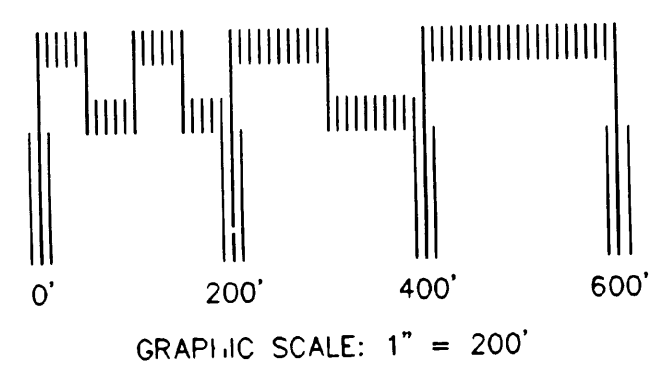

*Approved Jan 18, '96*